

SOCKET TYPE ILLUMINATED SWITCHES & PUSHBUTTON SWITCHES

Round



Accessories see page 13-14
 Technical data see page 2
 Ordering information see page 10

■ Mounting dimensions, mm



■ Bottom view

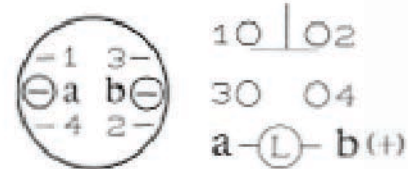

■ Dimensions, mm

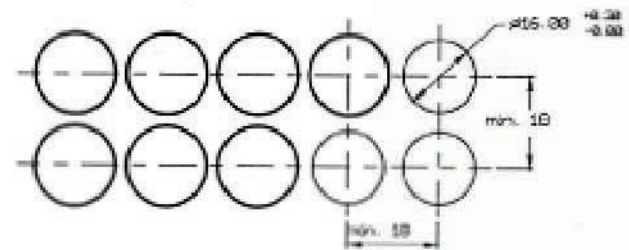

Description	Type	Contact block diagram (button not depressed)	Mounting length (A)
Illuminated or non-illuminated pushbutton 1 pole momentary action	SPST		40 mm
Illuminated or non-illuminated pushbutton 1 pole alternate action	SPST		40 mm

NOTES: As usual, silver contactors are commonly used. However, if it is used for small signal, we wish to recommend the use of gold plated contactors for which you are most welcome to contact with us for detailed specifications

SOCKET TYPE ILLUMINATED SWITCHES & PUSHBUTTON SWITCHES

Rectangular



■ Mounting dimensions, mm

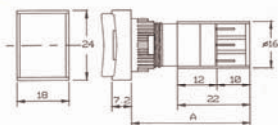

Accessories see page 13-14
 Technical data see page 2
 Ordering information see page 10

Bottom view

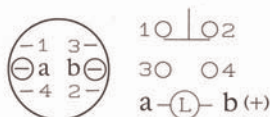

Dimensions, mm

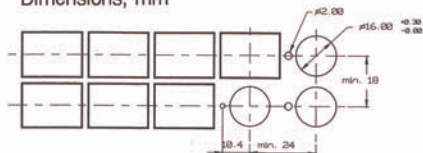

SOCKET TYPE ILLUMINATED SWITCHES & PUSHBUTTON SWITCHES

Square



■ Mounting dimensions, mm

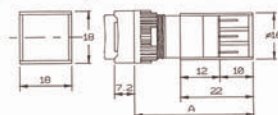

Accessories see page 13-14
 Technical data see page 2
 Ordering information see page 10

■ Bottom view

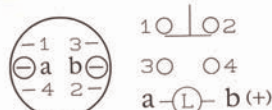

■ Dimensions, mm

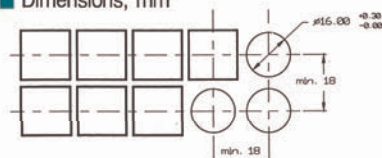

Description	Type	Contact block diagram (button not depressed)	Mounting length(A)
Illuminated or non-illuminated pushbutton 1 pole momentary action	SPST		40 mm
Illuminated or non-illuminated pushbutton 1 pole alternate action	SPST		40 mm

SOCKET TYPE PUSHBUTTON SWITCHES ORDER INFORMATION

Order no : P16 —

∅ 16 mm basic type : _____

Function : _____

LA : Socket type pushbutton switches with alternate action

LM : Socket type pushbutton switches with momentary action

Pushbutton head : _____

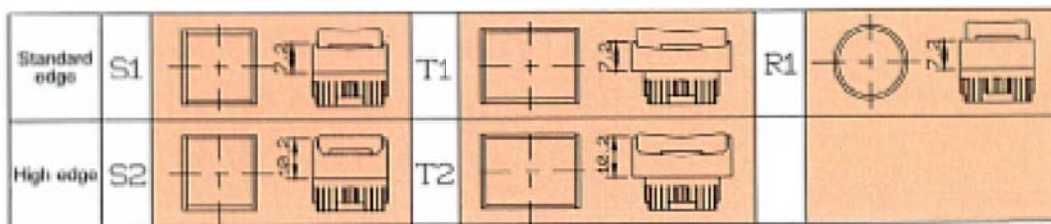

Contact Arrangement : _____

1ab : 1NO + 1NC

Lamp and Voltage : _____

O : Without lamp

A : Incandescent	6 V	AC/DC	200mA
B : Incandescent	14 V	AC/DC	80mA
C : Incandescent	28 V	AC/DC	40mA
F : Neon	110 V	AC	green / red
G : Neon	220 V	AC	green / red
H : LED	6 V	DC	green / yellow / red
J : LED	12 V	DC	green / yellow / red
K : LED	24 V	DC	green / yellow / red

Special type :

M : Incandescent	6 V	AC/DC	40mA
N : Incandescent	14V	AC/DC	40mA
L : Incandescent	33V	AC/DC	35mA
D : Incandescent	48V	AC/DC	25mA
E : Incandescent	60V	AC/DC	20mA

Color Lens : _____

B : Blue G : Green O : Orange
R : Red W : White Y : Yellow

Order Example :

If you want to order a round head illuminated pushbutton switch with a yellow color lens 60V DC 20 mA incandescent lamp, 1NO +1NC contact, alternate action

It's order # as : P16LAR1-1abEY

If you want to order a rectangular head with high edge, non-illuminated pushbutton switch with a red color lens, 1NO +1NC contact, momentary action

It's order # as : P16LMT2-1abOR